

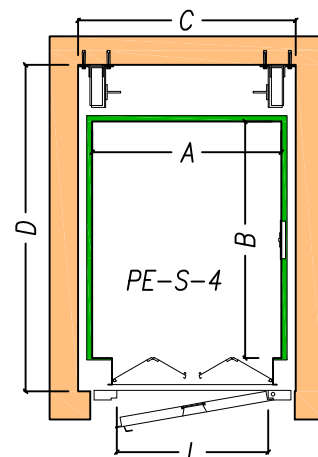

ascensori-montacarichi
 SAMER S.r.l.
 CORCIANO - PERUGIA

PIATTAFORMA ELEVATRICE SEMI-AUTOMATICA

SEMI AUTOMATIC VERTICAL LIFTING PLATFORM

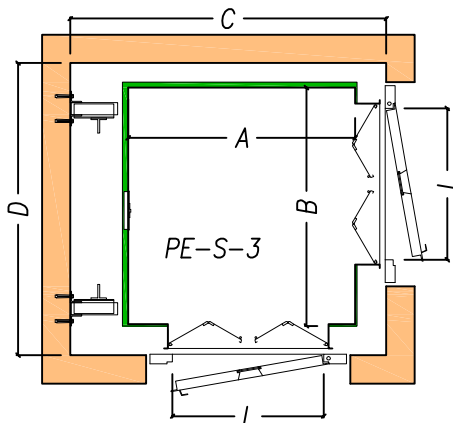
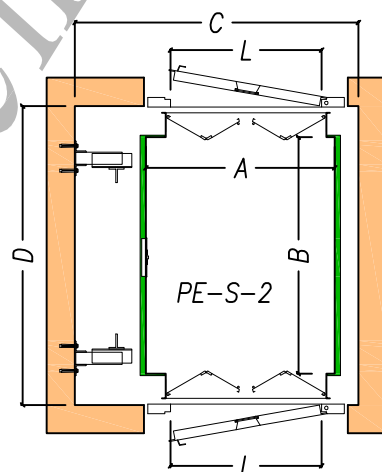
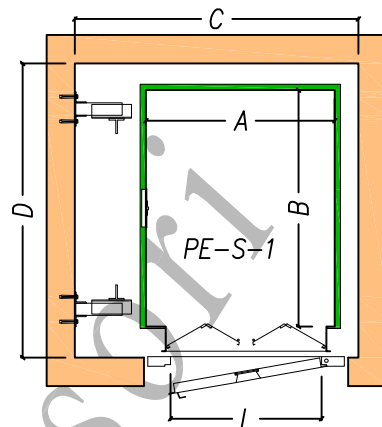
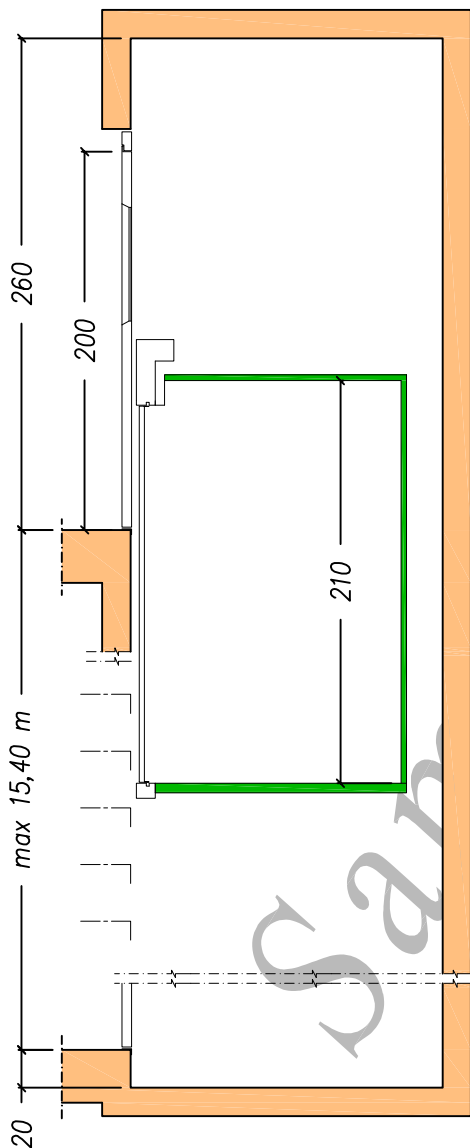

Piattaforma elevatrice semi-automatica							
Semi-automatic vertical lifting platform							
Tipo Type	Portata Load kg	Capienza Capacity	A cm	B cm	C cm	D cm	L cm
PE-S-1.a	300	3	80	125	120	150	75
PE-S-1.b	340	3	90	140	130	165	80
PE-S-1.c	340	3	100	125	140	150	80
PE-S-2.a	305	3	80	125	120	160	75
PE-S-2.b	350	3	90	140	130	175	80
PE-S-2.c	350	3	100	125	140	160	80
PE-S-3	395	3	110	140	160	165	80
PE-S-4	340	3	100	125	115	172	80

Norme di riferimento (Reference standard): Direttiva macchine 2006/42/CE

Disegno non in scala

SAMER si riserva il diritto di modificare senza preavviso le caratteristiche e le misure dei propri prodotti